

ROITHNER LASERTECHNIK

A-1040 WIEN, FLEISCHMANNGASSE 9

TEL: +43 -1- 586 52 43 FAX: +43 -1- 586 41 43

e-mail: office@roithner-laser.com http://www.roithner-laser.com

RLT80830G TECHNICAL DATA

High Power Infrared Laserdiode

Structure: **GaAlAs double heterostructure**

Lasing wavelength: **808 nm typ.**

Max. optical power: **30 mW**

Package: **9 mm**

PIN CONNECTION:

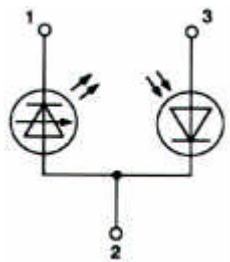

- 1) Laser diode cathode
- 2) Laser diode anode and photodiode cathode
- 3) Photodiode anode

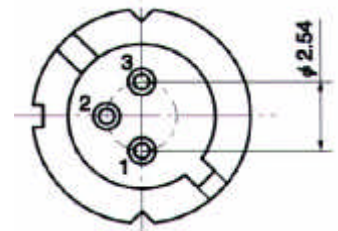

Absolute Maximum Ratings (Tc=25°C)

CHARACTERISTIC	SYMBOL	RATING	UNIT
Optical Output Power	P_o	30	mW
LD Reverse Voltage	$V_{R(LD)}$	2	V
PD Reverse Voltage	$V_{R(PD)}$	30	V
Operating Temperature	T_C	-10 .. +40	°C
Storage Temperature	T_{STG}	-40 .. +85	°C

Optical-Electrical Characteristics (Tc = 25°C)

CHARACTERISTIC	SYMBOL	TEST CONDITION	MIN	TYP	MAX	UNIT
Optical Output Power	P_o	cw			30	mW
Threshold Current	I_{th}	cw	20	30	50	mA
Operation Current	I_{op}	$P_o = 30 \text{ mW}$		80	100	mA
Operation Voltage	V_{op}	$P_o = 30 \text{ mW}$			2.7	V
Lasing Wavelength	λ_p	$P_o = 30 \text{ mW}$	790	808	810	nm
Beam Divergence	$\theta_{//}$	$P_o = 30 \text{ mW}$	5	8	11	°
Beam Divergence	θ_{\perp}	$P_o = 30 \text{ mW}$	25	31	37	°
Astigmatism	A_s	$P_o = 30 \text{ mW}, NA = 0.4$		5		μm
Monitor Current	I_m	$P_o = 30 \text{ mW}, V_f = 5V$		10		μA