

ROITHNER LASERTECHNIK

SCHOENBRUNNER STRASSE 7, 1040 VIENNA, AUSTRIA

TEL: +43 -1- 586 52 43-0 FAX: +43 -1- 586 52 43-44

office@roithner-laser.com www.roithner-laser.com

RLT831000G TECHNICAL DATA

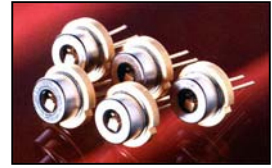

High Power Infrared Laserdiode

Lasing wavelength: **830 nm typ.**
Optical power: **1 W multimode**
Package: **9 mm**

NOTE!
LASERDIODE
MUST BE COOLED!

PIN CONNECTION:

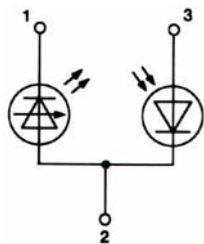

- 1) Laser diode cathode
- 2) Laser diode anode and photodiode cathode
- 3) Photodiode anode

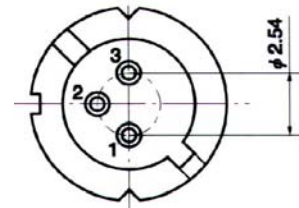

Absolute Maximum Ratings (T_c = 25°C)

CHARACTERISTIC	SYMBOL	RATING	UNIT
Optical Output Power	P _o	1.2	W
LD Reverse Voltage	V _{R(LD)}	0.5	V
PD Reverse Voltage	V _{R(PD)}	25	V
Operation Case Temperature	T _C	-30 .. +40	°C
Storage Temperature	T _{STG}	-60 .. +60	°C

Optical-Electrical Characteristics (T_c = 25°C)

CHARACTERISTIC	SYMBOL	TEST CONDITION	MIN	TYP	MAX	UNIT
Optical Output Power	P _o	cw		1		W
Threshold Current	I _{th}	cw		250	300	mA
Operation Current	I _{op}	P _o = 1 W		1.3	1.5	A
Operating Voltage	V _{op}	P _o = 1 W		1.8	2.4	V
Lasing Wavelength	λ _p	P _o = 1 W	825	830	835	nm
Spectral Width	Δλ	P _o = 1 W		3		nm
Beam Divergence	θ _{//}	P _o = 1 W	8	10	12	°
Beam Divergence	θ _⊥	P _o = 1 W	30	40	45	°
Monitor Current	I _m	P _o = 1 W	0.5	2.0	5.0	mA