

# **ROITHNER LASERTECHNIK**

A-1040 VIENNA, SCHOENBRUNNER STRASSE 7, AUSTRIA

TEL: +43 -1- 586 52 43-0 FAX: +43 -1- 586 52 43 44

office@roithner-laser.com www.roithner-laser.com

## **DDW-UJ2-TU1-1**

white SMD LED

## **DomiLED-White**

## **DATA SHEET**

**DATE : 2002/1/17**

**DEVICE NO :**

**REVISION : 0.1**

<b>CUSTOMER</b>	<b>DESIGNER</b>	<b>CHECKER</b>	<b>APPROVER</b>

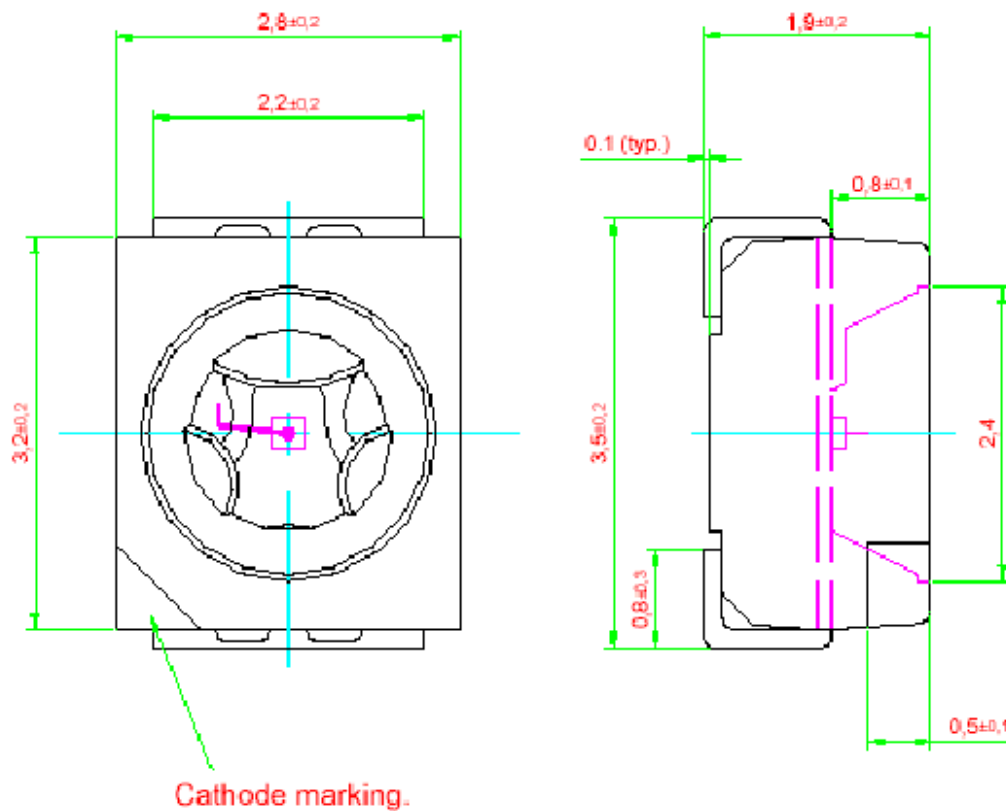

- High brightness surface mount LED.
- $120^\circ$  viewing angle.
- Small package outline (LxWxH) of 2.8 x 3.2 x 1.8 mm.
- Qualified according to JEDEC moisture sensitivity Level 2.
- Compatible to both IR reflow soldering and TTW soldering.

Part Ordering Number	Chip Technology / Color	Viewing angle	Luminous Intensity @If=20mA Iv(mcd)
	InGaN/Blue,460nm	120	
DDW-UJ2-TU1-1			<b>285.0 — 560.0</b>
● DDW-UJ2-T1-1			285.0 — 355.0
● DDW-UJ2-T2-1	355.0 — 450.0		
● DDW-UJ2-U1-1	450.0 — 560.0		

**NOTE:**

1. All part number above comes in a quantity of 2000 units per reel.
2. Luminous intensity is measured with an accuracy of  $\pm 11\%$ .
3. Color selection acc to chromaticity coordinates groups.

Color	Group	Chromaticity Coordinate Group				
		x	y	z	u	v
<b>DDW: White</b>	Full	x	0.26	0.26	0.35	0.35
		y	0.31	0.25	0.36	0.31
	W	x	0.26	0.26	0.29	0.29
		y	0.31	0.25	0.33	0.27
	X	x	0.29	0.29	0.32	0.32
		y	0.33	0.27	0.35	0.29
	Y	x	0.32	0.32	0.35	0.35
		y	0.35	0.29	0.37	0.31

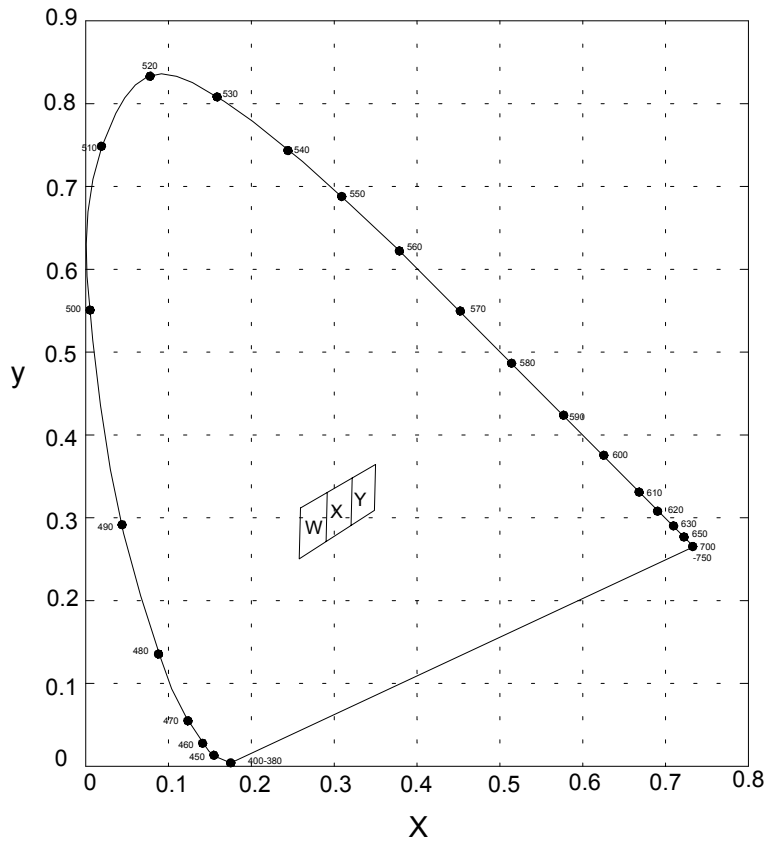

\* The C.I.E. 1931 chromaticity diagram

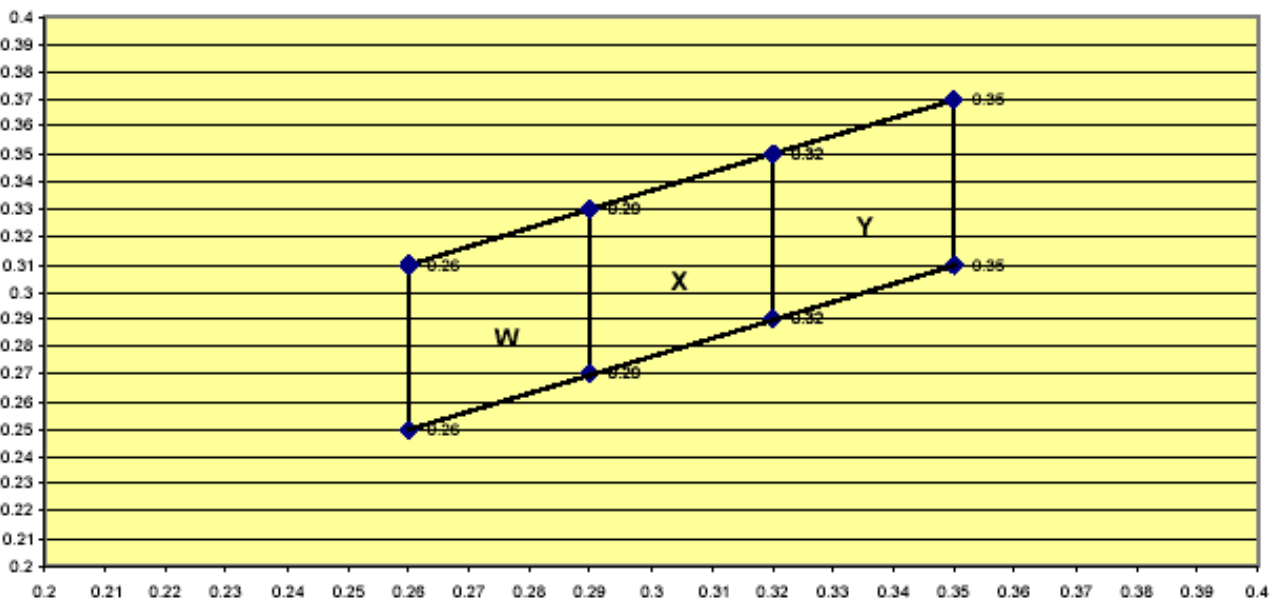

Chromaticity coordinate groups are measured with an accuracy of  $\pm 0.01$ .

### Vf Binning.

Vf Bin @ 20mA	Forward voltage (V)
Standard	3.35 ... 4.25
01	3.35 ... 3.65
02	3.65 ... 3.95
03	3.95 ... 4.25

Forward voltage, Vf is measured with an accuracy of  $\pm 0.05$  V.

### Absolute Maximum Ratings.

	Maximum Value	Unit
DC forward current.	20	mA
Peak pulse current; ( $t_p \leq 10 \mu s$ , Duty cycle = 0.005)	200	mA
Reverse voltage.	5	V
LED junction temperature.	125	$^{\circ}C$
Operating temperature.	-40 ... +100	$^{\circ}C$
Storage temperature.	-40 ... +100	$^{\circ}C$
Power dissipation ( at room temperature )	80	mW

### Recommended Solder Pad

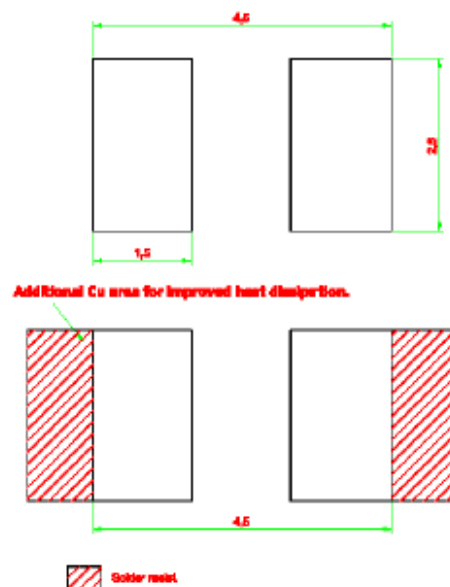

Relative luminous intensity vs. forward current.

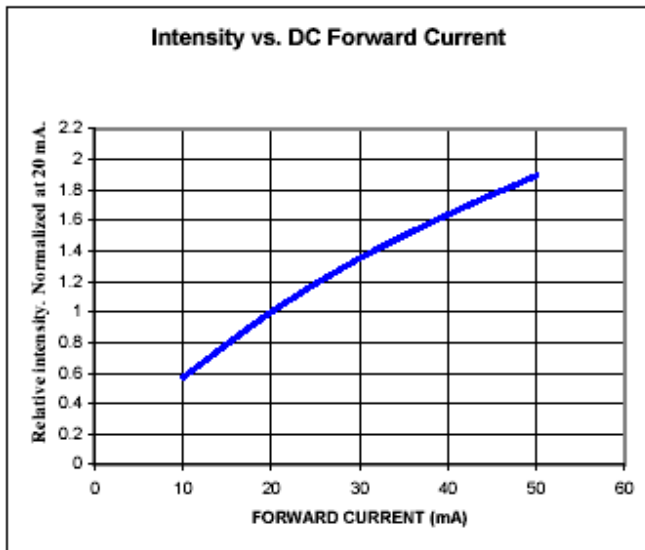

Forward current vs. forward voltage.

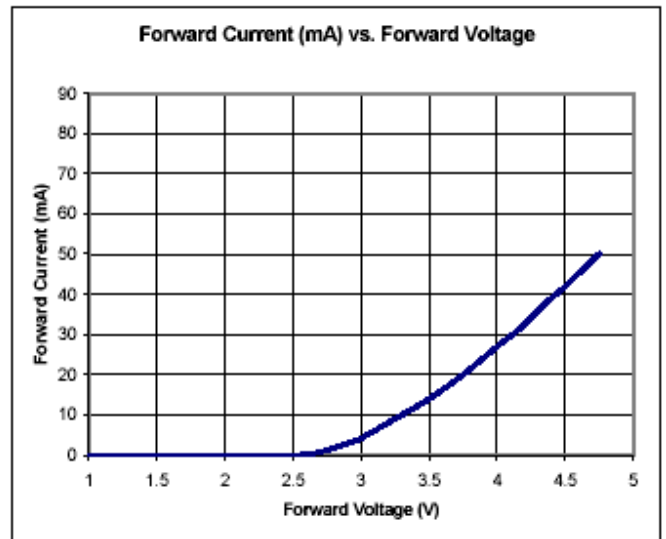

Radiation pattern.

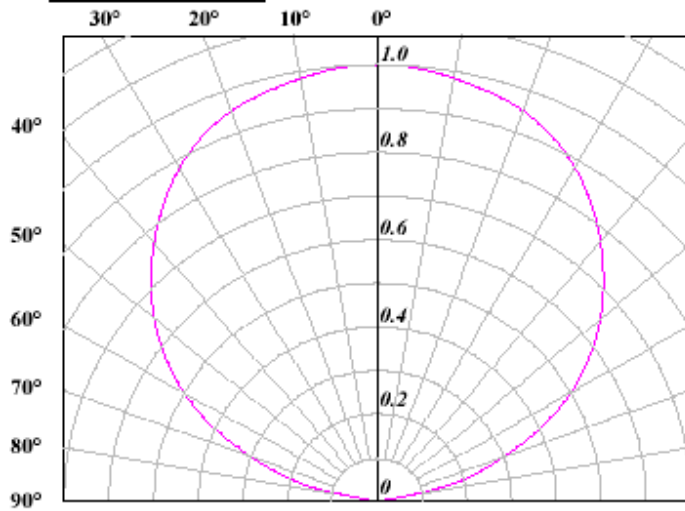

Maximum forward current vs. temperature.

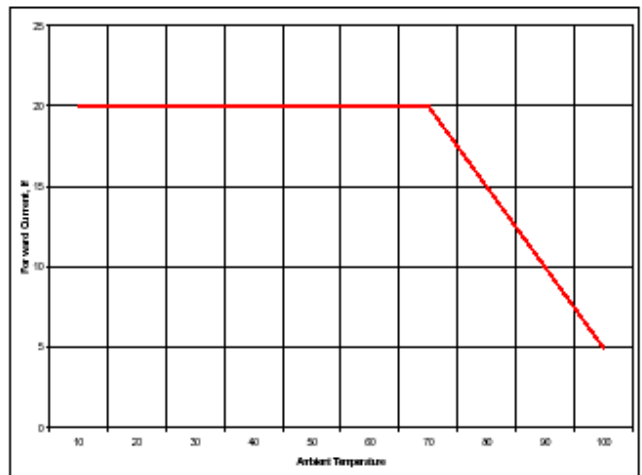

**Taping And Orientation.**

Reels come in quantity of 8000 units or 2000 units.  
Reel diameters are 330 mm and 180 mm respectively.

